



CRITICAL ENVIRONMENT PRODUCTS

FLUSH CEILING GRID SYSTEMS
FOR CLEANROOMS AND
HOSPITAL OR SUITES



92 SERIES: ***STERI-SUITE***

Integrated Laminar Airflow Technology and LED Lighting.



CRITICAL ENVIRONMENT PRODUCTS

TOP LOAD POWDER COATED EXTRUDED ALUMINUM FLUSH CEILING GRID SYSTEM

FEATURES:

- Laminar flow air distribution technology
- MERV 14, HEPA and ULPA filter options
- 2.5" Flush Ceiling Grid System with integrated lighting (T5, T8, LED)
- Factory welded grid modules are manufactured in sizes up to 8ft x 24ft
- Grid-to-grid connections have pre-machined bolt holes for ease of installation
- Grid modules have integrated fire protection
- Top Load with GEL seal integrated into the grid frame
- Bottom 'Snap-In' Flush Face Screen that aerodynamically evens the airflow under the grid modules
- Grid is a proven product with over 1 Million square feet installed
- Installation takes a fraction of the time, manpower, and cost of conventional stick-built systems
- Fall protection hardware available
- Seismic bracing available
- Ducted Filters and Fan Filter Units available

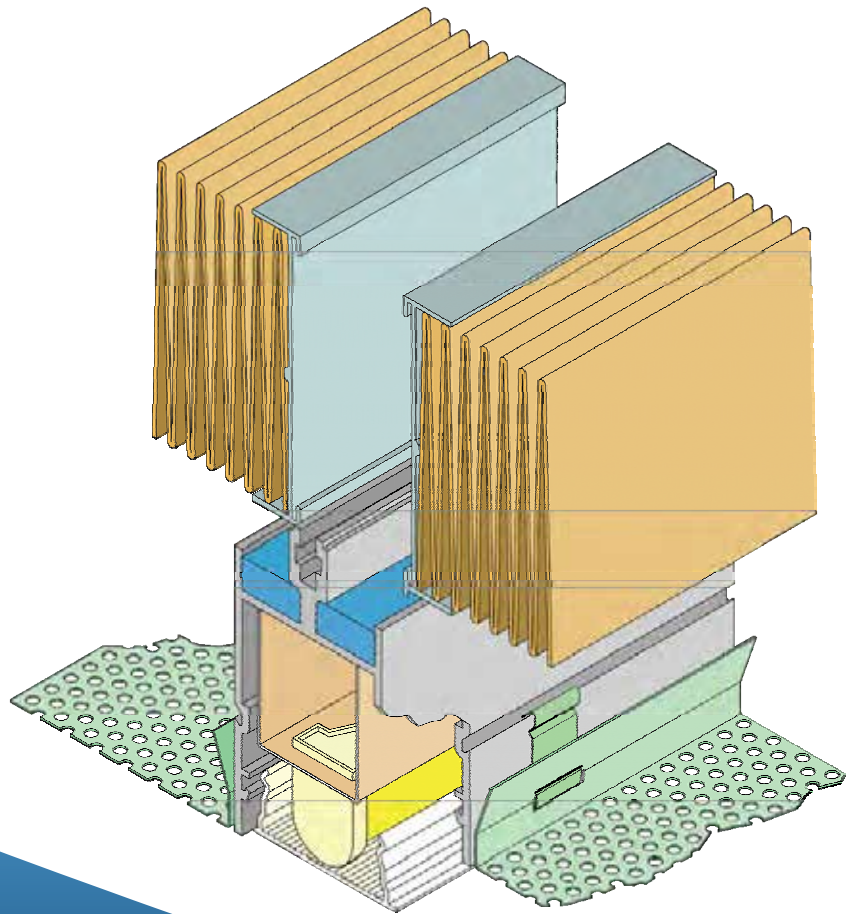

92 SERIES: *STERI-SUITE*

Integrated Laminar Airflow Technology and LED Lighting.

Nailor® STERI-SUITE

- ① Perimeter Grid 91249 - Extruded Aluminum
- ② Interior Grid 91229 - Extruded Aluminum
- ③ Integral Light Fixture, Ballast, Wire Separator, Fixture Clips
- ④ Sprinkler Penetration
- ⑤ Face Screen and Clips
- ⑥ Module to Module Connection
- ⑦ Electrical Conduit Penetration
- ⑧ Headtrack & Grid-to-Wall Closer
- ⑨ HEPA/ULPA Filter and Blank Pan
- ⑩ Corner Suspension Hanger
- ⑪ Interior Intersection Hanger and Seismic Bracing
- ⑫ Ducted Filter Module
- ⑬ Fan Filter Unit (FFU)

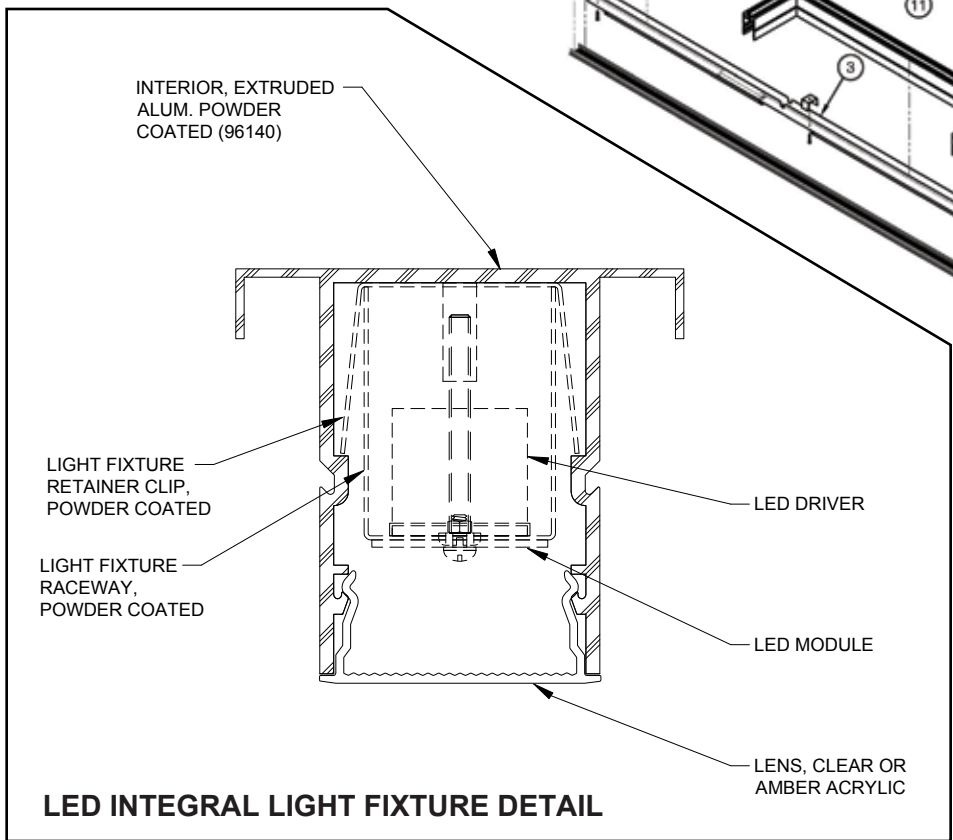
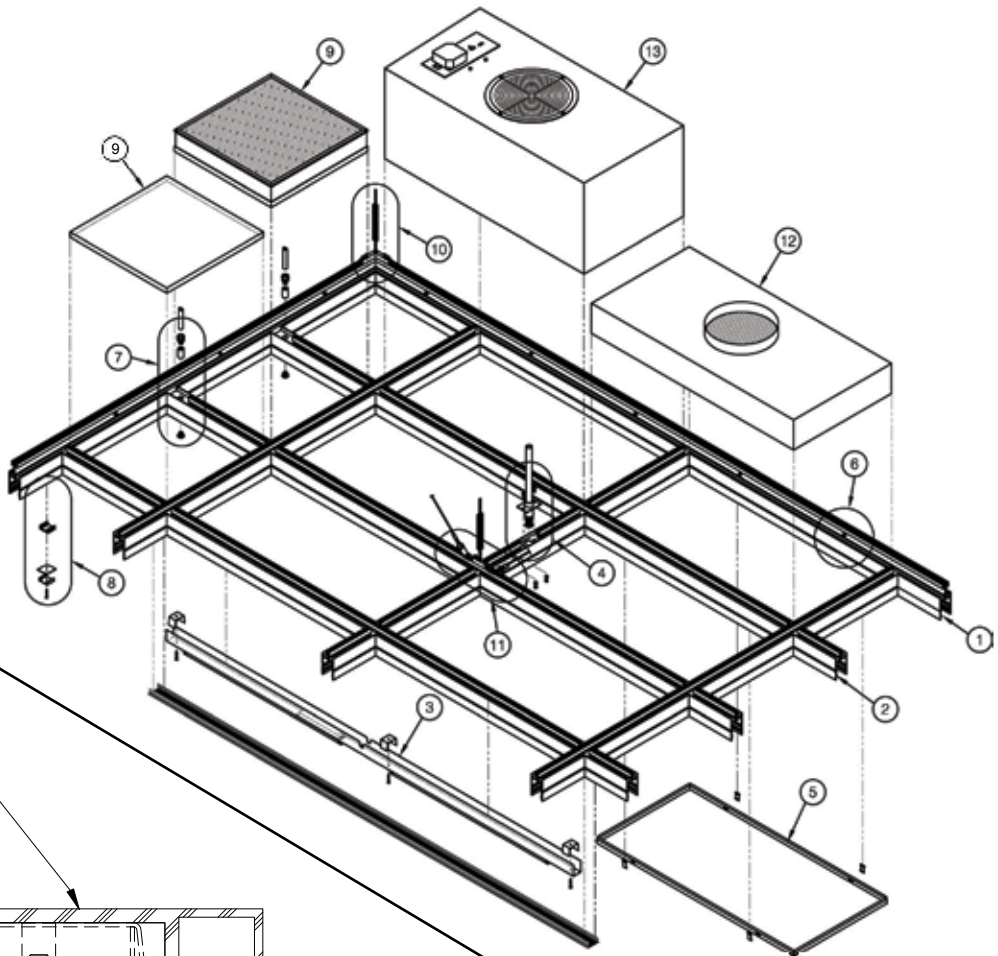



CRITICAL ENVIRONMENT PRODUCTS

BOTTOM LOAD POWDER COATED EXTRUDED ALUMINUM FLUSH CEILING GRID SYSTEM

FEATURES:

- Laminar flow air distribution technology
- MERV 14, HEPA and ULPA filter options
- 2.5" Flush Ceiling Grid System with integrated lighting (T5, T8, LED)
- Factory welded grid modules are manufactured in sizes up to 8ft x 24ft
- Grid-to-grid connections have pre-machined bolt holes for ease of installation
- Grid modules have integrated fire protection
- Bottom Load filters with integrated GEL seal
- Bottom 'Snap-In' Flush Face Screen that aerodynamically evens the airflow under the grid modules
- Grid is a proven product with over 1 Million square feet installed
- Installation takes a fraction of the time, manpower, and cost of conventional stick-built systems
- Fall protection hardware available
- Head Track connections available
- Seismic bracing available
- Ducted Filters and Fan Filter Units available

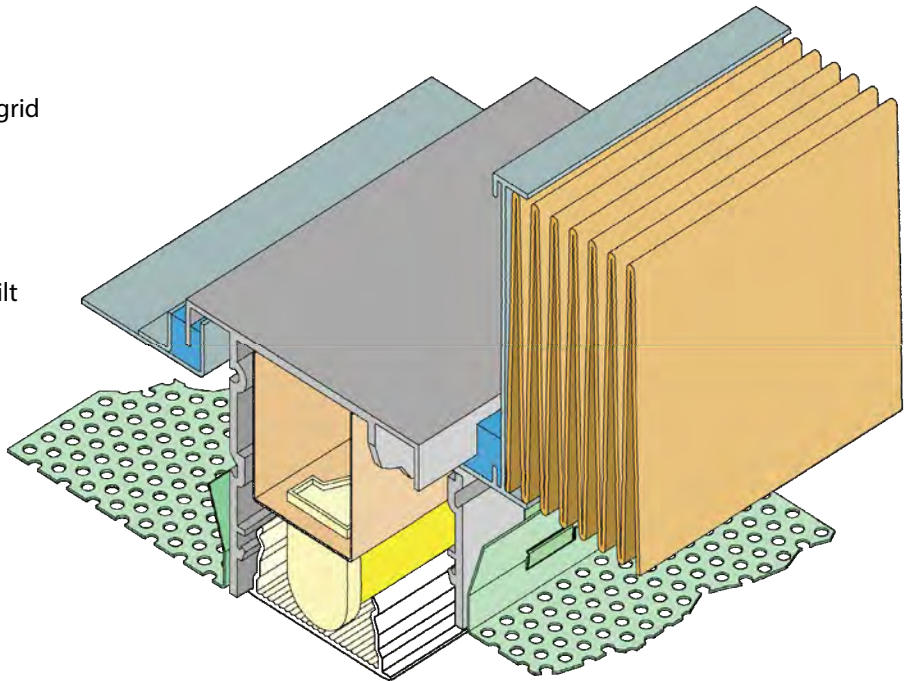

92 SERIES: *STERI-SUITE*

Integrated Laminar Airflow Technology and LED Lighting.

Nailor® STERI-SUITE

- ① Perimeter Grid 96141 - Extruded Aluminum
- ② Interior Grid 96140 - Extruded Aluminum
- ③ Integral Light Fixture, Ballast, Wire Separator, Fixture Clips
- ④ Sprinkler Penetration Detail
- ⑤ Face Screen and Clips
- ⑥ Module to Module Connection
- ⑦ Electrical Conduit Penetration
- ⑧ Headtrack & Grid-to-Wall Closer
- ⑨ HEPA/ULPA Filter and Blank Pan
- ⑩ Corner Suspension Hanger
- ⑪ Interior Intersection Hanger and Seismic Bracing
- ⑫ Ducted Filter Module
- ⑬ Fan Filter Unit (FFU)

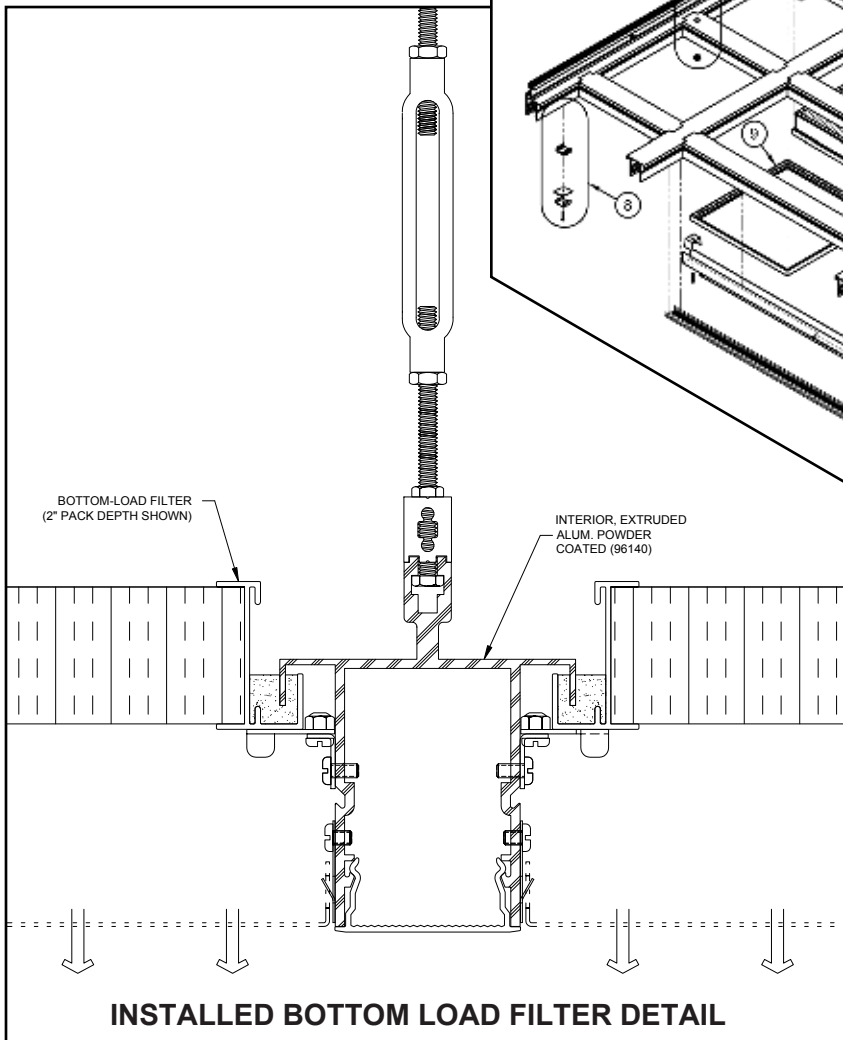
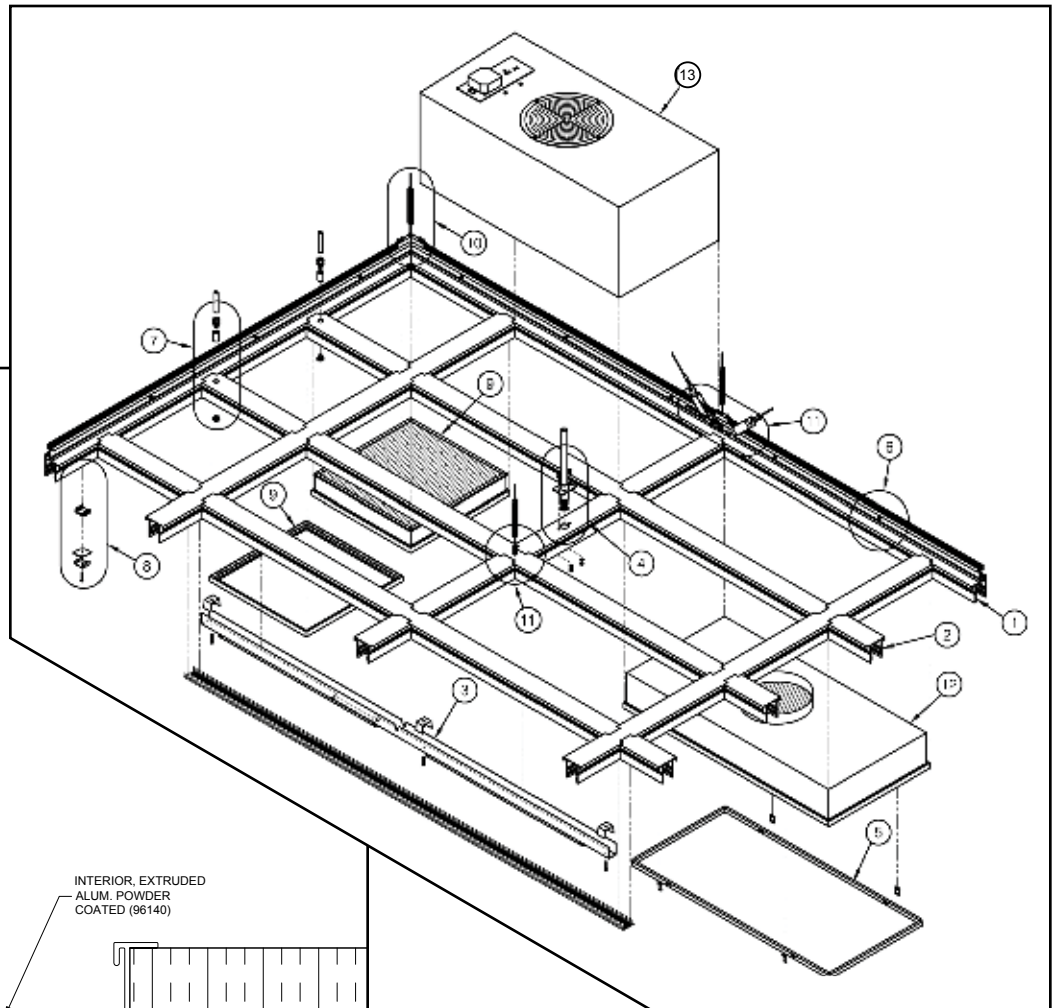



CRITICAL ENVIRONMENT PRODUCTS

BOTTOM LOAD STAINLESS STEEL FLUSH CEILING GRID SYSTEM

FEATURES:

- Laminar flow air distribution technology
- MERV 14, HEPA and ULPA filter options
- 2.5" Flush Ceiling Grid System with integrated lighting (T5, T8, LED)
- Factory welded grid modules are manufactured in sizes up to 8ft x 24ft
- Grid-to-grid connections have pre-machined bolt holes for ease of installation
- Stainless steel grid modules are constructed from 304 or 316 grade material
- Grid modules have integrated fire protection
- Bottom load filters with integrated GEL seal
- Bottom 'Snap-In' Flush Face Screen that aerodynamically evens the airflow under the grid modules
- Grid is a proven product with over 1 Million square feet installed
- Installation takes a fraction of the time, manpower, and cost of conventional stick-built systems
- Head Track connections available
- Seismic bracing available

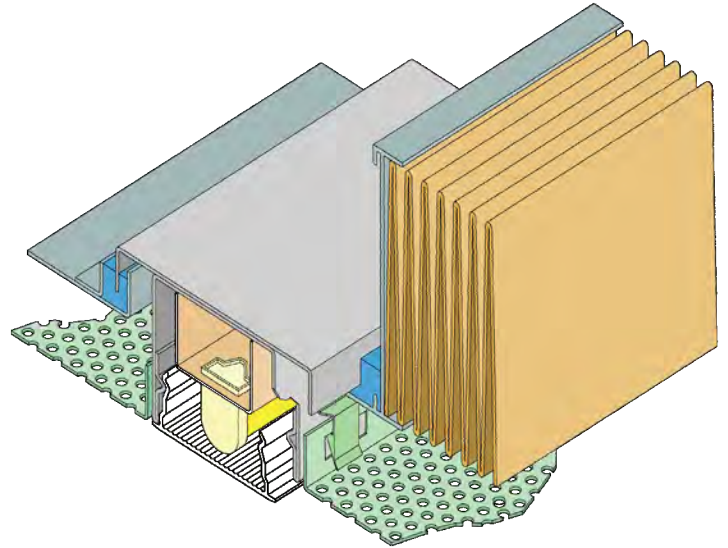

92 SERIES: *STERI-SUITE*

Integrated Laminar Airflow Technology and LED Lighting.

Nailor[®] STERI-SUITE

- ① Perimeter Grid - Stainless Steel
- ② Interior Grid - Stainless Steel
- ③ Integral Light Fixture, Ballast, Wire Separator, Fixture Clips
- ④ Sprinkler Penetration Detail
- ⑤ Face Screen and Clips
- ⑥ Module to Module Connection
- ⑦ Electrical Conduit Penetration
- ⑧ Grid-Wall Connection Detail
- ⑨ HEPA/ULPA Filter and Blank Pan
- ⑩ Corner Connection Hanger
- ⑪ Interior Intersection Hanger

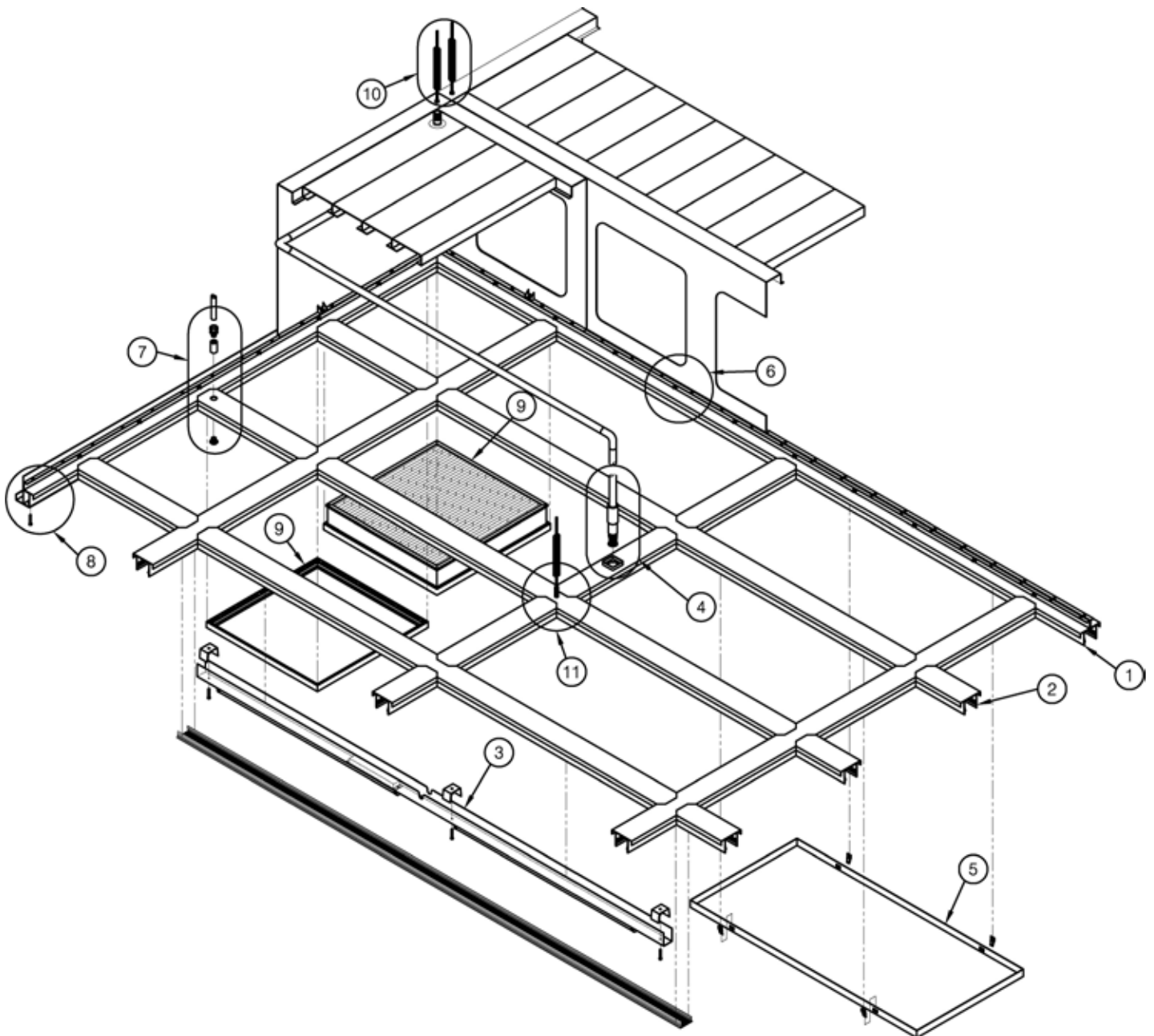

CRITICAL ENVIRONMENT PRODUCTS

PLENUM MODULES FLUSH CEILING GRID SYSTEM

FEATURES:

- Plenum modules provide direct support for recirculation air handlers
- Plenum modules eliminate the need for field built plenums
- Plenum modules reduce pressure drop within the cleanroom ceiling system
- Modules can be manufactured with shared air openings to balance air flow to adjacent plenums
- Plenum modules can be attached to either top load, bottom load, or stainless steel flush grid systems
- Plenum-to-plenum connections have pre-punched bolt holes for ease of installation
- Plenum modules are suspended from existing structure or a custom floor mounted structure can be provided
- Plenum modules have integrated fire protection
- Plenum modules have integrated electrical wiring
- Modules are available in sizes up to 8ft x 24ft

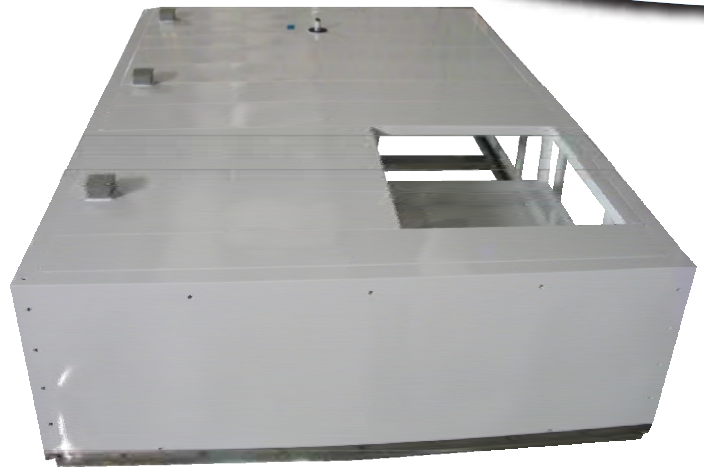

TOP OF PLENUM MODULE SHOWN WITH
DIFFUSION SCREEN AND STAINLESS GRID



BOTTOM FACE OF PLENUM MODULE
SHOWN WITH SPRINKLER AND LIGHTS

92 SERIES: *STERI-SUITE*

Integrated Laminar Airflow Technology and LED Lighting.

Nailor® STERI-SUITE

- ① Plenum Side and End Wall
- ② Plenum Roof Panels
- ③ Reinforcement for Roof Support and Leveling Grid Below
- ④ Vertical Plenum Stiffeners
- ⑤ Corner Connection Angle
- ⑥ Module to Module Connection
- ⑦ Module to Module Shared Air Opening
- ⑧ Module to Module Connection or Structural Column Support Point
- ⑨ Corner Suspension Point
- ⑩ Plenum Supply Air Opening
- ⑩ Mid-Span Suspension Point
- ⑪ Electrical Junction Box
- ⑫ Sprinkler Drop Penetration

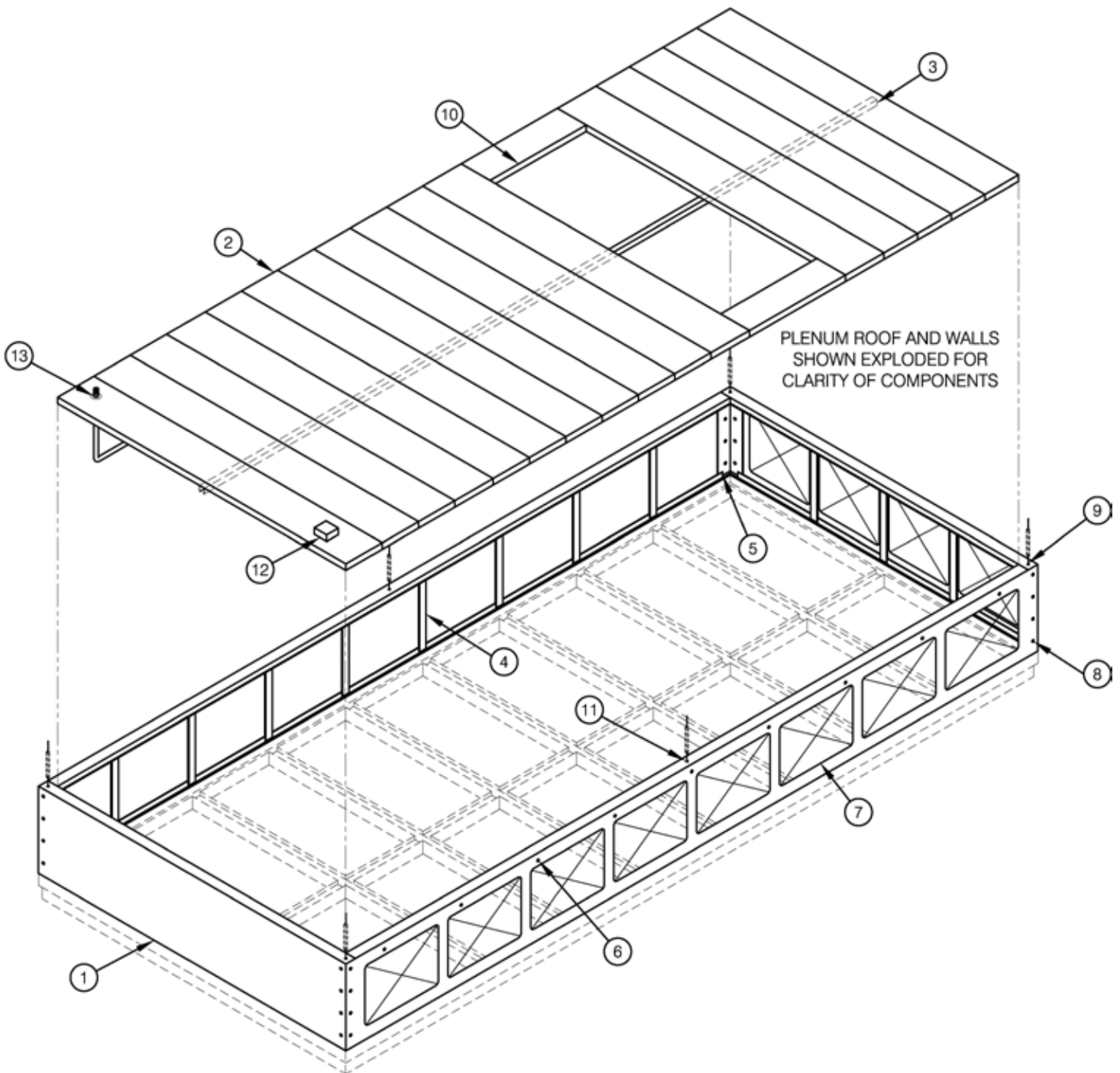

CRITICAL ENVIRONMENT PRODUCTS

FAN POWERED PLENUM MODULES FLUSH CEILING GRID SYSTEM

FEATURES:

- Fan powered plenums are ideal for retrofits with no space available for recirculation air handlers
- Provides great redundancy in the system
- Available with complete control system, controlled by a PC with interface to building management systems
- Wall Mount Fan Controller - can control up to 200 fan and motor assemblies
- Available with handheld controller to individually set and control each fan/motor assembly
- Plenum modules eliminate the need for field built plenums
- Modules can be manufactured with shared air openings to balance air flow to adjacent plenums
- Plenum modules are suspended from existing structure or a custom floor mounted structure can be provided
- Plenum modules have integrated fire protection
- Plenum modules have integrated electrical wiring
- Modules are available in sizes up to 8ft x 24ft



SHOWN WITH
RETURN AIR PLENUM



INSIDE FAN POWERED PLENUM MODULE

92 SERIES: *STERI-SUITE*

Integrated Laminar Airflow Technology and LED Lighting.

Nailor[®] STERI-SUITE

- ① Plenum Side and End Wall
- ② Plenum Roof Panels
- ③ Reinforcement for Roof Support and Leveling Grid Below
- ④ Vertical Plenum Stiffeners
- ⑤ Corner Connection Angle
- ⑥ Module to Module Connection
- ⑦ Module to Module Shared Air Opening
- ⑧ Module to Module Connection or Structural Column Support Point
- ⑨ Corner Suspension Point
- ⑩ TPA - Fan Powered Plenum
- ⑪ Mid-Span Suspension Point
- ⑫ Electrical Junction Box
- ⑬ Sprinkler Drop Penetration

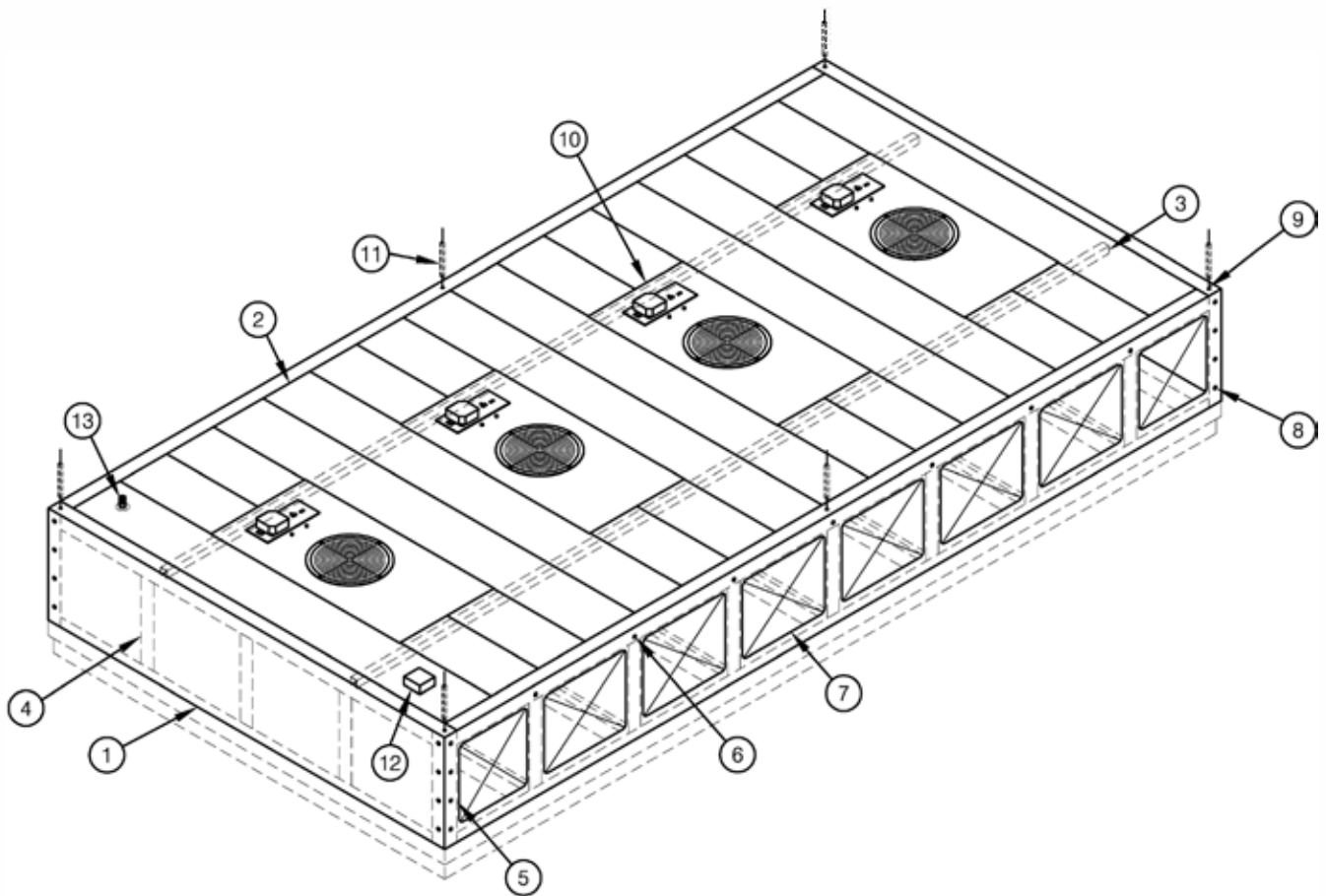
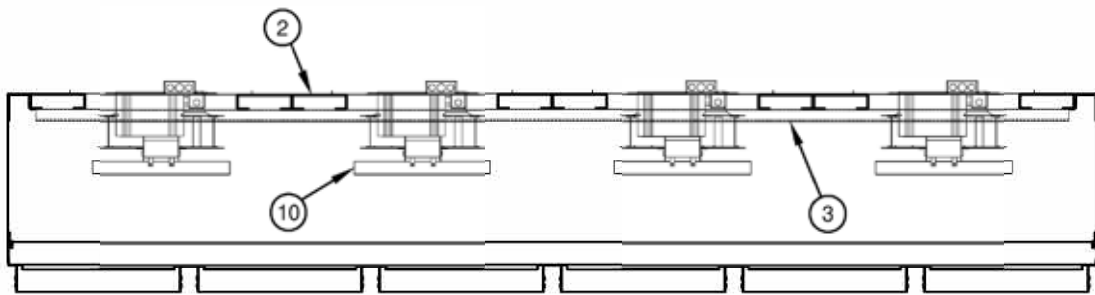



CRITICAL ENVIRONMENT PRODUCTS



FLUSH CEILING GRID SYSTEMS

- Top Load extruded aluminum ceiling grid system
- Bottom Load extruded aluminum ceiling grid system
- Bottom Load stainless steel ceiling grid system

PLENUM MODULES

- Plenum Modules with integrated lighting, fire protection and filtration systems
- Fan Powered Plenum Modules with integrated custom control systems

AIR HANDLERS BY THERMAL CORPORATION

- Recirculation Air Handlers with Direct Drive fans
- Custom Make-up Air Handlers.

LAMINAR FLOW AND RADIAL PATTERN HOSPITAL/CLEANROOM DIFFUSERS

- Aluminum and Stainless Steel Models
- Steri-System OR Air Curtain Systems

