



SERENITY VERTICAL STACK WATER SOURCE HEAT PUMP WITH OUTSIDE AIR DAMPER (OAI) AND ECM MOTOR CONCEALED, MASTER AND SLAVE MODELS: 44VHB AND 44VCB • UNIT SIZES 9 – 36

MODEL: 44VHB

☐ **Concealed** (default)

(Stand-alone)

☐ **M Master**

☐ **S Slave**

Cabinet Options:

☐ **SSS Standard** (default)
(Chassis ships separately)

☐ **SWC Standard**
(Shipped with Chassis)

MODEL: 44VCB

(Heat Pump Chassis only)

STANDARD FEATURES:

- 20 ga. (1.0) galvanized steel casing.
- Outside Air Damper (right location is illustrated).
- Removable chassis allows staged installation and ease of maintenance.
- ECM Ultra-high efficiency fan motor with overload protection.
- High-efficiency rotary & scroll compressors.
- Stainless steel braided hose kits for connection from piping risers to chassis.
- TXV metering device.
- 1/2" (13) dual density insulation, exposed edges coated to prevent air erosion.
- 1" (25) throwaway filter.
- Stainless steel insulated drain pans.
- Factory installed P-Trap.
- Integrated drain pan with condensate overflow sensor.
- Multiple supply air discharge options, factory or field configurable.
- Unique double isolation compressor mounting for quiet operation.
- Front return panel with AW Appliance White powder coat finish.
- Exceeds ASHRAE 90.1 efficiencies.

Dimensional Data

Unit Size	Footprint A x B	Supply Grille Nominal DW x DH	Cabinet SSS/SWC H	Filter Size
9, 12	17 x 17 (432 x 432)	15 x 10 (281 x 254)	88 (2236)	14 x 24 (356 x 610)
15, 19	20 x 20 (508 x 508)	18 x 10 (457 x 254)		16 x 25 (406 x 635)
24	24 x 24 (610 x 610)	22 x 10 (559 x 254)		20 x 25 (508 x 635)
30, 36	24 x 24 (610 x 610)	22 x 10 (559 x 254)		20 x 30 (508 x 762)

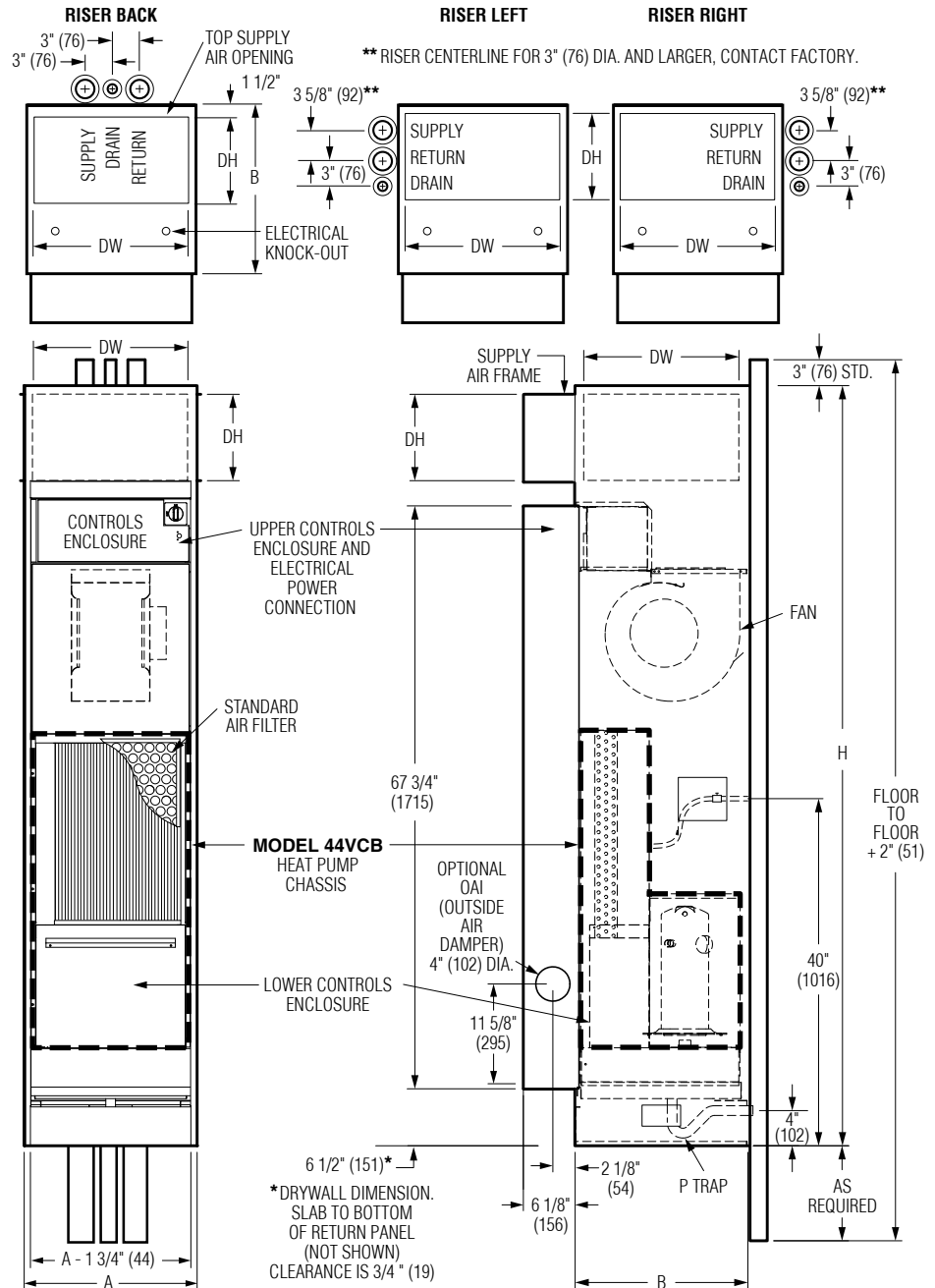

SCHEDULE TYPE:

PROJECT:

ENGINEER:

CONTRACTOR:

DATE

B SERIES

SUPERSEDES

DRAWING NO.

2 - 17 - 25

44

NEW

44VHB-2

Page 1 of 2.

Dimensions are in inches (mm).



**SERENITY VERTICAL STACK WATER SOURCE
HEAT PUMP WITH ECM MOTOR
CONCEALED, MASTER AND SLAVE
MODEL SERIES: 44VHB • MODEL: 44VCB
UNIT SIZES 9 – 36**

GENERAL INFORMATION

Unit Size	CFM	GPM	Cooling		Heating		Compressor		Charge (oz)
			Capacity (btuh)	EER	Capacity (btuh)	COP	Qty.	Type	
9	325	3	10000	15.1	12000	5.2	1	Rotary	27
12	425	3.5	12000	15.3	14800	5.1	1	Rotary	26
15	500	4.5	14800	15.8	18200	5.3	1	Rotary	37
19	625	5.5	19000	16	24000	5.0	1	Scroll	36
24	800	7	24500	15.8	27800	4.6	1	Scroll	62
30	1000	8	29400	16.2	31500	4.7	1	Scroll	62
36	1200	9	35500	16.1	38200	4.6	1	Scroll	62

ELECTRICAL DATA

Unit Size	Voltage	Horsepower - RPM	Blower FLA	Compressor RLA / LRA	Total FLA	MCA	Breaker Size
9	208/1	1/4	1.1	4.0 / 22	5.1	6.1	15
	265/1	1/4	1.0	4.0 / 23	5	6.0	15
12	208/1	1/4	1.4	4.6 / 25	6	7.2	15
	265/1	1/4	1.2	3.9 / 21	5.1	6.1	15
15	208/1	1/3	1.8	5.2 / 26	7.0	8.3	15
	265/1	1/3	1.6	4.7 / 21	6.3	7.5	15
19	208/1	1/3	1.8	8.3 / 45.1	10.1	12.2	20
24	208/1	1/3	2.4	10.3 / 60.2	12.7	15.3	25
	265/1	1/3	2.1	10.3 / 60.5	12.4	15.0	25
30	208/1	1/3	3.2	11.9 / 67.8	15.1	18.1	30
	265/1	1/3	2.9	10.9 / 71.7	13.8	16.5	25
36	208/1	1/2	3.7	13.5 / 82.5	17.2	20.6	35
	265/1	1/2	3.3	12.2 / 83	15.5	18.6	30

OPTIONS:

- ☐ 1" (25) MERV 8 pleated filter.
- ☐ 2" (51) MERV 8 pleated filter.
- ☐ Plaque return panel with optional finishes.
- ☐ Full riser chase.
- ☐ Factory provided risers.
- ☐ Stainless steel drain pans.
- ☐ Toggle disconnect switch.
- ☐ Door interlocking type disconnect switch.

- ☐ Cabinet stand.
- ☐ Tamper proof fasteners.
- ☐ Condensate pump.
- ☐ Insulated heat exchanger.
- ☐ Thermostat/Controls (by Engineered Comfort).
- ☐ Special features: _____.

Voltage:

- Single phase, 60 Hz.
- ☐ 208V/230V
 - ☐ 265V

NOTES:

1. Wiring from electrical entry knock-out to controls enclosure is furnished and field installed by others.
2. Risers available from 3/4" (19) to 3" (76) dia..
3. Max. riser length is 120" (3048), 100" (2540) min.
4. Back riser location shown.
5. For indoor use only.

SCHEDULE TYPE:

PROJECT:

ENGINEER:

CONTRACTOR:

Page 2 of 2.
Dimensions are in inches (mm).

DATE

B SERIES

SUPERSEDES

DRAWING NO.

2 - 17 - 25

44

NEW

44VHB-2