



LINEAR SLOT DIFFUSER PLENUMS
 WITH CABLE OPERATED INLET DAMPER
 5000 SERIES • LINEAR SLOT DIFFUSER ACCESSORY
 1 - 4 SLOT
MODEL SERIES: 5300(MP) WITH IDCO OPTION

**1 THROUGH 4 SLOT
 STANDARD MODELS:**

- 5375 • 3/4" (19) Slot
- 5310 • 1" (25) Slot
- 5315 • 1 1/2" (38) Slot

**MODIFIED PERFORMANCE
 MODELS:**

- 5375MP • 3/4" (19) Slot
- 5310MP • 1" (25) Slot
- 5315MP • 1 1/2" (38) Slot

Hemmed Leg Frame Types: C, D, J, N
Straight Leg Frame Types: A, B, E, F, FL, G, H, H2, KA, K1, K2, M, T

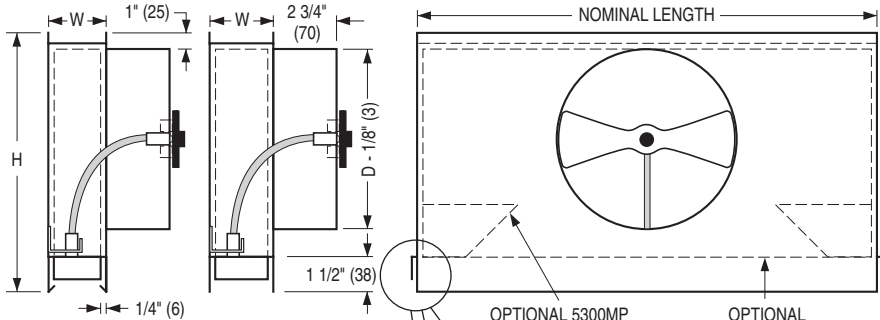

Nominal Length		Standard Nominal Inlets (D)	
inches	mm	inches	mm
20	508	6, 8, 10	152, 203, 254
24	610		
30	762		
36	914	6, 8, 10, 12, 14	152, 203, 254, 305, 356
48	1219		
60	1524		
72	1829		

Inlet Size D (Round)	Plenum Height (H)
6 (152), 8 (203)	11 (279)
10 (254)	13 (330)
12 (305)	15 (381)
14 (356)	17 (432)

Model	No. of Slots	Plenum Width (W) For Various Frame Types							
		Imperial Units (inches)				Metric Units (mm)			
		A, B, FL, KA, K1, K2, M, T	C, D, F, J, H, H2, N	E	G	A, B, FL, KA, K1, K2, M, T	C, D, F, J, H, H2, N	E	G
5375	1	1 3/4	2 1/4	2 1/2	2 3/4	44	57	64	70
5310		2	2 1/2	2 3/4	3	51	64	70	76
5315		2 1/2	3	3 1/4	3 1/2	64	76	83	89
5375	2	3 1/4	3 3/4	4	4 1/4	83	95	102	108
5310		3 3/4	4 1/4	4 1/2	4 3/4	95	108	114	121
5315		4 3/4	5 1/4	5 1/2	5 3/4	121	133	140	146
5375	3	4 3/4	5 1/4	5 1/2	5 3/4	121	133	140	146
5310		5 1/2	6	6 1/4	6 1/2	140	152	159	165
5315		7	7 1/2	7 3/4	8	178	191	197	203
5375	4	6 1/4	6 3/4	7	7 1/4	159	171	178	184
5310		7 1/4	7 3/4	8	8 1/4	184	197	203	210
5315		9 1/4	9 3/4	10	10 1/4	235	248	254	260

NOTES:

- Construction: Corrosion-resistant steel.
- Nailor Series 5300 Plenums are designed specifically for field attachment to the 5000 Series Linear Slot Diffuser. They ensure optimum use of the 5000 Series VAV performance, providing a tight horizontal air pattern even at low volumes. Optional MP models incorporate integral baffles, which provide a reduction in throw and increased spread of the air pattern.
- End caps can be turned up to allow plenums to be installed on continuous runs. Simple installation with a flexible duct connection.
- The round inlet damper is Nailor's 4250 radial sliding blade design factory mounted on the inlet. 5315 and 5310: A flexible rotary cable connects the damper to a Phillips head screw operator mounted inside the plenum that permits air balancing at the diffuser face. 5375: Flexible rotary cable with male square rotary end and nylon cable clamp adjusts with a 1/4" (6) hex nut driver. Cable is threaded through diffuser face during installation for balancing and pushed back in afterwards.

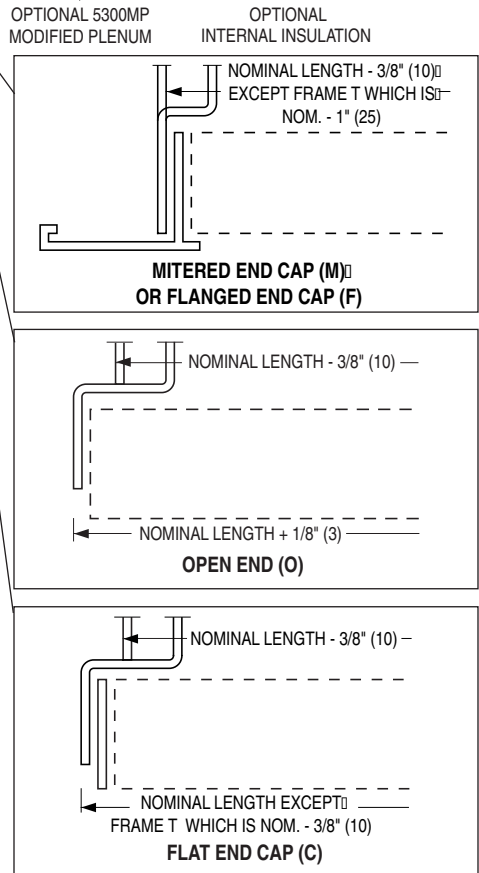

ACCESSORIES (OPTIONAL):

- Internal Insulation:
 - 5375I(MP) 3/4" (19) slot.
 - 5310I(MP) 1" (25) slot.
 - 5315I(MP) 1 1/2" (38) slot.
- 1b. FGI 1/4" (6) coated fiberglass.
- FFI 3/8" (10) fiber-free foam.
2. EX External Foil Back Insulation.

Dimensions are in inches (mm).

SCHEDULE TYPE:				
PROJECT:				
ENGINEER:	DATE	B SERIES	SUPERSEDES	DRAWING NO.
CONTRACTOR:	2 - 26 - 20	5300	12 - 23 - 19	5300-3