



**LINEAR SLOT DIFFUSER PLENUMS**  
 WITH CABLE OPERATED INLET DAMPER  
 5000 SERIES • LINEAR SLOT DIFFUSER ACCESSORY  
 5 - 8 SLOT  
**MODEL SERIES: 5300(MP) WITH IDCO OPTION**

**5 THROUGH 8 SLOT**

**STANDARD MODELS:**

- 5375 • 3/4" (19) Slot
- 5310 • 1" (25) Slot
- 5315 • 1 1/2" (38) Slot

**MODIFIED PERFORMANCE MODELS:**

- 5375MP • 3/4" (19) Slot
- 5310MP • 1" (25) Slot
- 5315MP • 1 1/2" (38) Slot

**Hemmed Leg Frame Types:** C, D, J, N  
**Straight Leg Frame Types:** A, B, E, F, FL, G, H, H2, KA, K1, K2, M, T

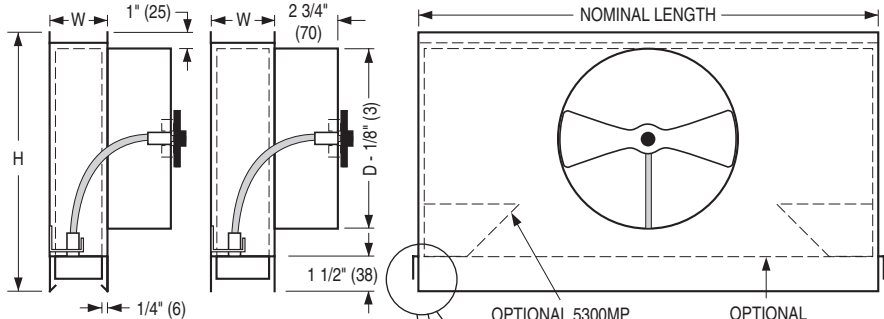

Nominal Length		Standard Nominal Inlets (D)	
inches	mm	inches	mm
20	508	6, 8, 10	152, 203, 254
24	610		
30	762		
36	914	6, 8, 10, 12, 14	152, 203, 254, 305, 356
48	1219		
60	1524		
72	1829		

Inlet Size D (Round)	Plenum Height (H)
6 (152), 8 (203)	11 (279)
10 (254)	13 (330)
12 (305)	15 (381)
14 (356)	17 (432)

Model	No. of Slots	Plenum Width (W) For Various Frame Types							
		Imperial Units (inches)				Metric Units (mm)			
		A, B, FL, KA, K1, K2, M, T	C, D, F, J, H, H2, N	E	G	A, B, FL, KA, K1, K2, M, T	C, D, F, J, H, H2, N	E	G
5375	5	7 3/4	8 1/4	8 1/2	8 3/4	197	210	216	222
5310		9	9 1/2	9 3/4	10	229	241	248	254
5315		11 1/2	12	12 1/4	12 1/2	292	305	311	318
5375	6	9 1/4	9 3/4	10	10 1/4	235	248	254	260
5310		10 3/4	11 1/4	11 1/2	11 3/4	273	286	292	298
5315		13 3/4	14 1/4	14 1/2	14 3/4	349	362	368	375
5375	7	10 3/4	11 1/4	11 1/2	11 3/4	273	286	292	298
5310		12 1/2	13	13 1/4	13 1/2	318	330	337	343
5315		16	16 1/2	16 3/4	17	406	419	425	432
5375	8	12 1/4	12 3/4	13	13 1/4	311	324	330	337
5310		14 1/4	14 3/4	15	15 1/4	362	375	381	387
5315		18 1/4	18 3/4	19	19 1/4	464	476	483	489

**NOTES:**

- Construction: Corrosion-resistant steel.
- Nailor Series 5300 Plenums are designed specifically for field attachment to the 5000 Series Linear Slot Diffuser. They ensure optimum use of the 5000 Series VAV performance, providing a tight horizontal air pattern even at low volumes. Optional MP models incorporate integral baffles, which provide a reduction in throw and increased spread of the air pattern.
- End caps can be turned up to allow plenums to be installed on continuous runs. Simple installation with a flexible duct connection.
- The round inlet damper is Nailor's 4250 radial sliding blade design factory mounted on the inlet. 5315 and 5310: A flexible rotary cable connects the damper to a Phillips head screw operator mounted inside the plenum that permits air balancing at the diffuser face. 5375: Flexible rotary cable with male square rotary end and nylon cable clamp adjusts with a 1/4" (6) hex nut driver. Cable is threaded through diffuser face during installation for balancing and pushed back in afterwards.

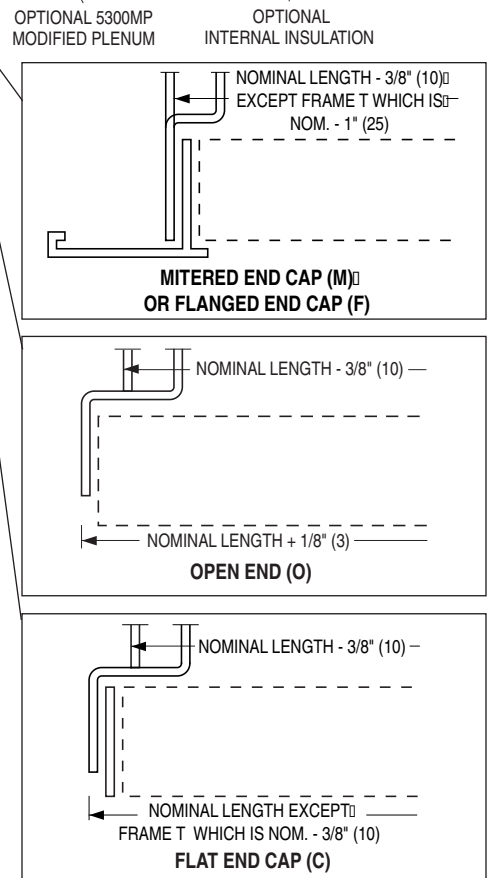

**ACCESSORIES (OPTIONAL):**

- Internal Insulation:
  - 5375I(MP) 3/4" (19) slot.
  - 5310I(MP) 1" (25) slot.
  - 5315I(MP) 1 1/2" (38) slot.
- 1b.  FGI 1/4" (6) coated fiberglass.
- FFI 3/8" (10) fiber-free foam.
2.  EX External Foil Back Insulation.

Dimensions are in inches (mm).

<b>SCHEDULE TYPE:</b>			
<b>PROJECT:</b>			
<b>ENGINEER:</b>			
<b>CONTRACTOR:</b>			
<b>DATE</b>	<b>B SERIES</b>	<b>SUPERSEDES</b>	<b>DRAWING NO.</b>
2 - 26 - 20	5300	12 - 23 - 19	5300-4