

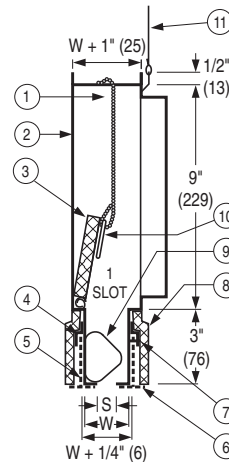

FIRE RATED PLENUM SLOT DIFFUSER
CURVED BLADE 'FLIP FLOP' PATTERN
CONTROLLERS • 3 HR. RATING
MODEL: 5575

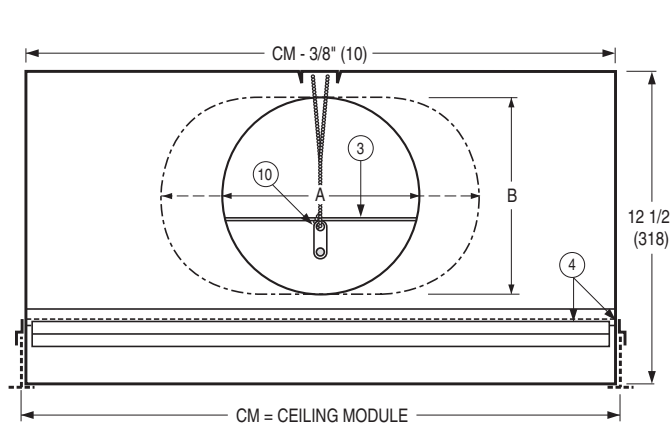

MODEL 5575

3/4" (19) Slot width

1, 2, 3 and 4-slot models available.

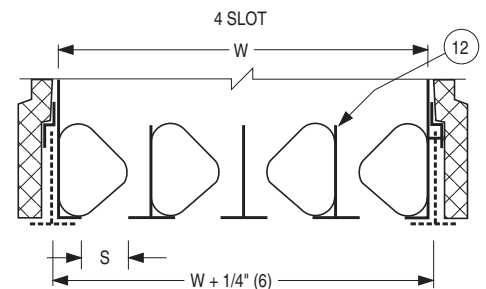
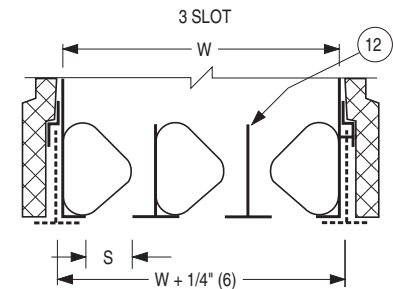
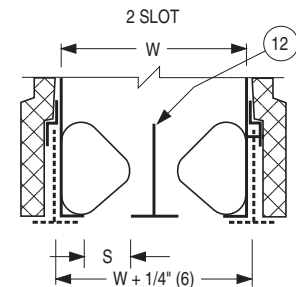

DESCRIPTION:

1. The 5500 Series is a UL Classified fire rated Air Terminal Unit listed in Underwriters Laboratories Fire Resistance Directory. All diffusers are classified for use in UL/ULC restrained or unrestrained floor/ceiling and or roof/ceiling assemblies which incorporate an exposed grid suspended ceiling (lay-in T-bar) with up to a 3 hour rating. For details of fire rated assemblies, see the current UL or ULC Fire Resistance Directory.
2. Construction: Corrosion resistant steel. 212°F (100°C) fusible link is standard.
3. Finish: Black pattern controllers and exposed surfaces. AW Appliance White on center T-Bars.
4. 'Flip-flop' pattern controllers provide a tight horizontal ceiling pattern. An excellent choice for VAV systems.
5. Standard nominal lengths: 20", 24", 36", 48" and 60" (500, 600, 900, 1200 and 1500). Standard inlet sizes: 5", 6", 7", 8" (127, 152, 178, 203) are round. Oval sizes are 9", 10" and 12" (229, 254 and 305).

* For installation instructions, see IOM-FRPINST.

ITEMS:

1. Fusible link damper support chain.
2. Diffuser casing.
3. Insulated, hinged damper blade.
4. Clip for ceiling grid member – 4 sides.
5. Existing grid member.
6. Supplementary ceiling grid member. UL Listed (optional or by others).
7. #8 screws for grid member attachment.
8. Thermal shroud.
9. Adjustable pattern controller. The position can be as shown or rotated 180° to opposite position.
10. UL Listed fusible link (replaceable).
11. Hanger wire at casing mid-point.
12. Intermediate grid bars supplied and installed by factory.

OPTIONS:

1. Non-standard temperature U.L. Listed fusible link.
 - 165 165°F (74°C)
2. ID Inlet Damper
3. EX External Foil Back Insulation.
4. Supplementary ceiling grid (T-Bar) member (UL Listed).
 - T1 One (inlet side).
 - T0 One (opposite inlet side).

| | | S = 3/4" (19) |
|--------------|--------|---------------|
| W (Width) | 1 slot | 1 11/16" (43) |
| | 2 slot | 3 3/8" (86) |
| | 3 slot | 5 1/16" (129) |
| | 4 slot | 6 3/4" (171) |

| | | Nominal Inlet Size | | | |
|---|--|--------------------|-------------------|-------------------|-------------------|
| | | 6" (152) Round | 8" (203) Round | 10" (254) Oval | 12" (305) Oval |
| A | | 5 7/8" (149) | 7 7/8" (200) | 11" (279) | 14 1/8" (359) |
| B | | - | - | 7 7/8" (200) | 7 7/8" (200) |

SCHEDULE TYPE:

PROJECT:

ENGINEER:

CONTRACTOR:

Dimensions are in inches (mm).

| DATE | B SERIES | SUPERSEDES | DRAWING NO. |
|-------------|----------|--------------|-------------|
| 1 - 16 - 17 | 5500 | 11 - 11 - 15 | 5500-1 |