



**FLOWLINE™ LINEAR SLOT DIFFUSERS**  
**ARCHITECTURAL • ALUMINUM**  
**OPTIONS AND ACCESSORIES**  
**MODEL SERIES: FLH AND FLV**

**Mitered Corners**

- FLMC10 • 1" (25) Slot
- FLMC15 • 1 1/2" (38) Slot
- FLMC20 • 2" (51) Slot
- FLMC25 • 2 1/2" (64) Slot
- FLMC30 • 3" (76) Slot

The standard mitered corners are 90° and 135°. Units are factory welded with precision to match and align with the associated straight leg.

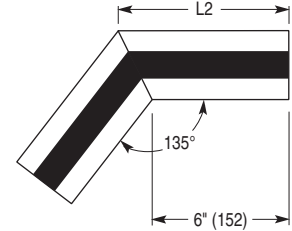
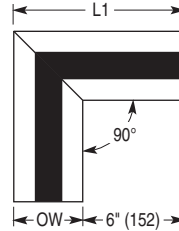

Units are supplied with factory installed blank-offs in the slot (painted black) and are inactive. Other angles are available.

**Special Mitered Corners**

- Other Angle \_\_\_\_\_.

\*Available from 45 – 179° as SPL. (A detailed sketch is required for co-ordination with installing contractors).

No. of Slots	Slot Width	Border AA		Border CC		Border GG	
		L1	L2	L1	L2	L1	L2
1	1 (25)	9 9/16 (243)	7 15/32 (190)	10 3/8 (264)	7 13/16 (198)	8 11/16 (221)	7 1/8 (181)
	1 1/2 (38)	10 9/16 (268)	7 7/8 (200)	11 3/8 (289)	8 1/4 (209)	9 11/16 (246)	7 17/32 (191)
	2 (51)	11 9/16 (294)	8 5/16 (211)	12 3/8 (315)	8 5/8 (219)	10 11/16 (271)	7 15/16 (202)
	2 1/2 (64)	12 9/16 (319)	8 23/32 (221)	13 3/8 (340)	9 1/16 (230)	11 11/16 (297)	8 11/32 (212)
	3 (76)	13 9/16 (344)	9 1/8 (232)	14 3/8 (365)	9 1/2 (241)	12 11/16 (322)	8 3/4 (222)
2	1 (25)	11 31/32 (304)	8 15/32 (215)	12 13/16 (325)	8 13/16 (224)	11 3/32 (282)	8 3/32 (206)
	1 1/2 (38)	13 31/32 (355)	9 5/16 (237)	14 13/16 (376)	9 5/8 (244)	13 3/32 (333)	8 29/32 (226)
	2 (51)	15 31/32 (406)	10 1/8 (257)	16 13/16 (427)	10 1/2 (267)	15 3/32 (383)	9 3/4 (248)
	2 1/2 (64)	17 31/32 (456)	10 31/32 (279)	18 13/16 (477)	11 5/16 (287)	17 3/32 (434)	10 9/16 (268)
	3 (76)	19 31/32 (507)	11 25/32 (299)	20 13/16 (529)	12 1/8 (308)	19 3/32 (485)	11 13/32 (290)

**Transitions**

**Type C Cross**

- FLC10 • 1" (25) Slot
- FLC15 • 1 1/2" (38) Slot
- FLC20 • 2" (51) Slot
- FLC25 • 2 1/2" (64) Slot
- FLC30 • 3" (76) Slot

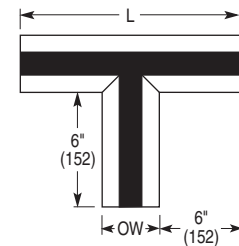
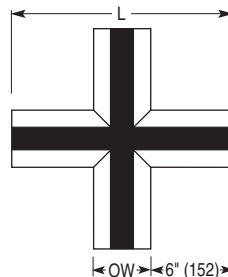

**Type T Tee**

- FLT10 • 1" (25) Slot
- FLT15 • 1 1/2" (38) Slot
- FLT20 • 2" (51) Slot
- FLT25 • 2 1/2" (64) Slot
- FLT30 • 3" (76) Slot

Transitions are inactive. Blank-offs installed at factory. Not available in 2 slot version.

No. of Slots	Slot Width	Border AA		Border CC		Border GG	
		OW	L	OW	L	OW	L
1	1 (25)	3 9/16 (90)	15 9/16 (395)	4 3/8 (111)	16 3/8 (416)	2 3/4 (70)	14 11/16 (373)
	1 1/2 (38)	4 9/16 (116)	16 9/16 (421)	5 3/8 (137)	17 3/8 (442)	3 3/4 (95)	15 11/16 (398)
	2 (51)	5 9/16 (141)	17 9/16 (446)	6 3/8 (162)	18 3/8 (467)	4 3/4 (121)	16 11/16 (424)
	2 1/2 (64)	6 9/16 (167)	18 9/16 (471)	7 3/8 (188)	19 3/8 (493)	5 3/4 (146)	17 11/16 (449)
	3 (76)	7 9/16 (192)	19 9/16 (497)	8 3/8 (213)	20 3/8 (518)	6 3/4 (171)	18 11/16 (475)

**SCHEDULE TYPE**

**PROJECT**

**ENGINEER**

**CONTRACTOR**

Page 1 of 4  
 Dimensions are in inches (mm).

**DATE**

**B SERIES**

**SUPERSEDES**

**DRAWING NO.**

4 - 23 - 21

FL

2 - 12 - 21

FLAC-1

**Return Hood / Sight Shield**
**Uninsulated:**

- FLRS10 • 1" (25) Slot
- FLRS15 • 1 1/2" (38) Slot
- FLRS20 • 2" (51) Slot
- FLRS25 • 2 1/2" (64) Slot
- FLRS30 • 3" (76) Slot

**Insulated:**

- FLRSI10 • 1" (25) Slot
- FLRSI15 • 1 1/2" (38) Slot
- FLRSI20 • 2" (51) Slot
- FLRSI25 • 2 1/2" (64) Slot
- FLRSI30 • 3" (76) Slot

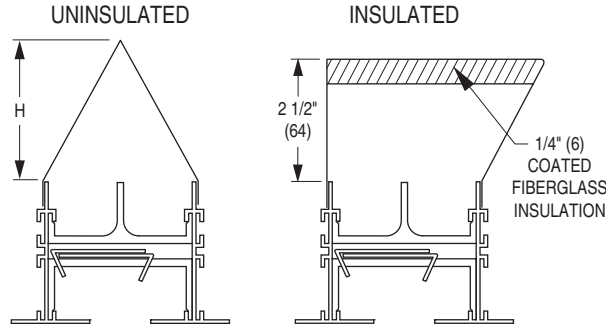

No. of Slots	Slot Width	H Height
1	1 (25)	3 3/8 (86)
	1 1/2 (38)	3 3/8 (86)
	2 (51)	3 3/8 (86)
	2 1/2 (64)	3 3/8 (86)
	3 (76)	3 3/8 (86)
2	1 (25)	2 1/8 (54)
	1 1/2 (38)	3 1/8 (79)
	2 (51)	4 1/8 (105)
	2 1/2 (64)	5 1/8 (130)
	3 (76)	6 1/8 (156)

**Notes:**

1. Material: 51% free area perforated corrosion resistant steel.
2. Available from 12" to 96" (305 to 2438) in 1" (25) increments.
3. Field cut to length if necessary.
4. Finish: Flat Black

**SCHEDULE TYPE**
**PROJECT**
**ENGINEER**
**CONTRACTOR**

 Page 2 of 4  
 Dimensions are in inches (mm).

**DATE**
**B SERIES**
**SUPERSEDES**
**DRAWING NO.**

4 - 23 - 21

FL

2 - 12 - 21

FLAC-1



**FLOWLINE™ LINEAR SLOT DIFFUSERS**  
**ARCHITECTURAL • ALUMINUM**  
**OPTIONS AND ACCESSORIES**  
**MODEL SERIES: FLH AND FLV**

**Blank-Offs**

- FLBO10 • 1" (25) Slot
- FLBO15 • 1 1/2" (38) Slot
- FLBO20 • 2" (51) Slot
- FLBO25 • 2 1/2" (64) Slot
- FLBO30 • 3" (76) Slot

Corrosion resistant steel, painted flat black. Fits in neck of diffuser. Provided in 48" (1219) lengths. Field cut to length.

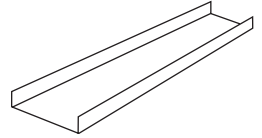

**Mounting Clips**

- HC1 Hard Ceiling Clip 5/8"
- HC5 Hard Ceiling Clip 1/2"

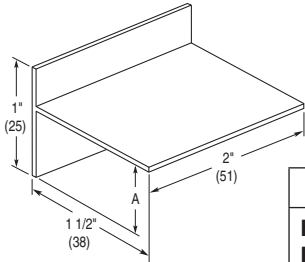

	A Dim.
HC1	5/8" (16)
HC5	1/2" (13)

The HC1 and HC5 Hard Ceiling Clip can be used to mount the FlowLine™ assembly with frame/border types **AA**, **CC** or **GG**, where 5/8" (16) or 1/2" (13) gypsum wallboard (drywall) is used.

**Exposed Flange Frame Type AA**

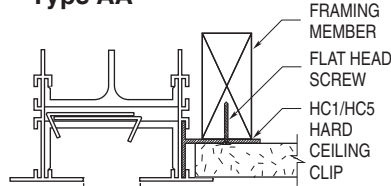

**Concealed Tapered Frame Type CC**

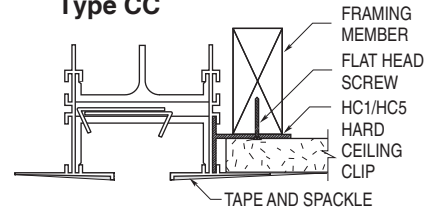

**Flangeless Flush Frame Type GG**

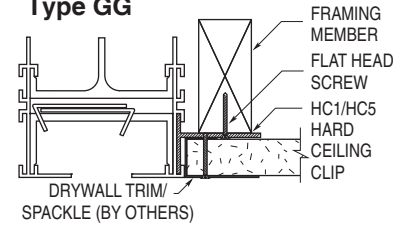

**WC1 Wall Clip**

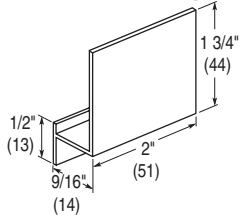

The WC1 WallClip is used to mount the FlowLine™ assembly with frame/border type **AA** flush to a wall.

**Ceiling / Sidewall Type AA**

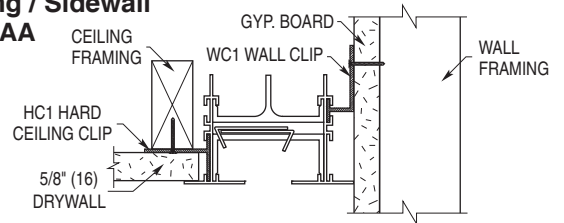

**TC1 T-Bar Clip (Field Formed)**

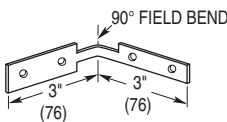

The TC1 T-Bar Clip is used to attach drop tees to the FlowLine™ assembly.

**Ceiling T-Bar Type AA**

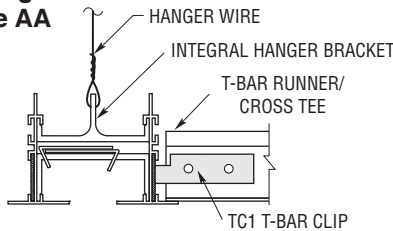

**Ceiling T-Bar (Bolt Slot) Type GG**

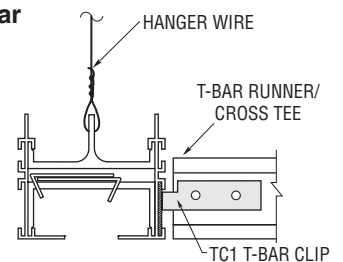

**TC2 Finline T-Bar Clip**

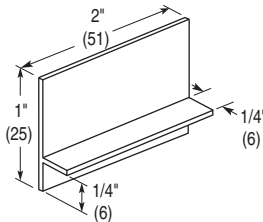

The TC2 Finline T-Bar Clips are used to support and level the Flowline™ assembly in Bolt-Slot (Finline type) suspension systems.

**Flangeless Frame Type GG**

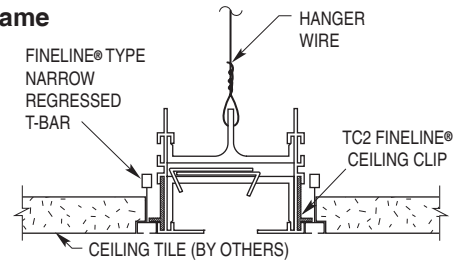

SCHEDULE TYPE

PROJECT

ENGINEER

CONTRACTOR

Page 3 of 4  
 Dimensions are in inches (mm).

DATE	B SERIES	SUPERSEDES	DRAWING NO.
4 - 23 - 21	FL	2 - 12 - 21	FLAC-1

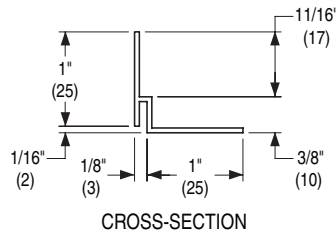
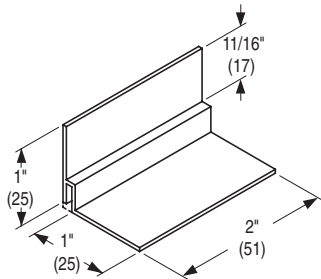
**Mounting Clips**
 **HC2 Hard Ceiling Clip**

The HC2 Hard Ceiling Clip can be used to mount the FlowLine™ assembly with frame/border type **G**, where standard 5/8" (16) gypsum wallboard (drywall) is installed below the frame face.

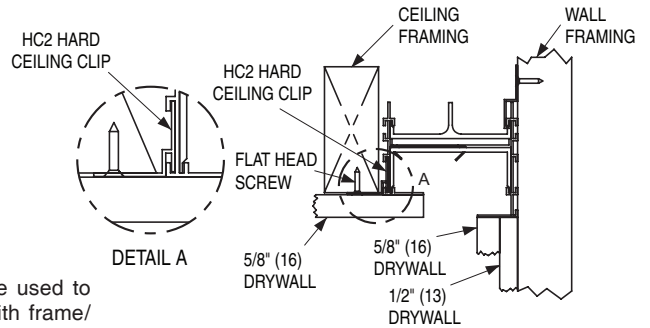
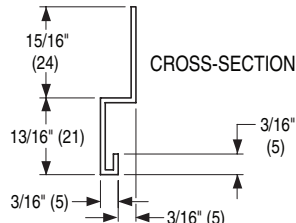
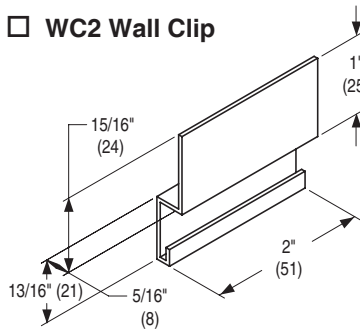
 **Flangeless Concealed Frame Type GJ**
 **WC2 Wall Clip**

The WC2 Wall Clip can be used to mount the FlowLine™ assembly with frame/border types **G** or **J**, flush to a wall.

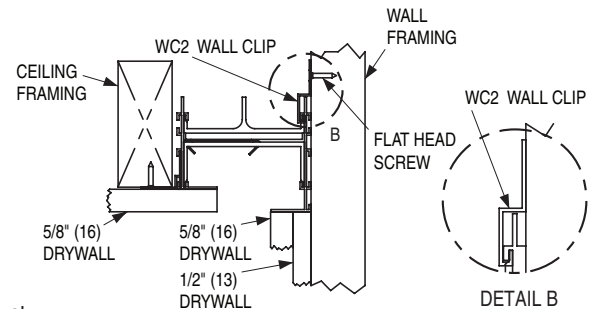
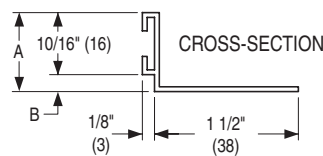
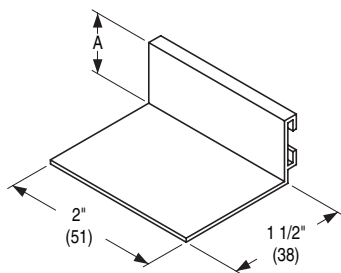
 **Flangeless Concealed Frame Type GJ**
 **HC3 Hard Ceiling Clip for Type K Border**

The HC3 Hard Ceiling Clip can be used to mount the FlowLine™ assembly with frame/border type **K**, where standard 5/8" (16) gypsum wallboard (drywall) is used.

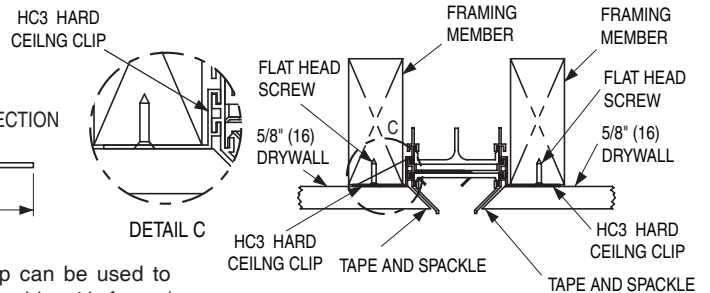
 **Flangeless Concealed Frame Type KK**

Flowline	Part No.	A Dim.	B Dim.
FLH10	HC3-10	13/16 (21)	3/16 (5)
FLH15	HC3-15	1 1/16 (27)	7/16 (11)
FLH20	HC3-20	1 5/16 (33)	11/16 (17)

**SCHEDULE TYPE**
**PROJECT**
**ENGINEER**
**CONTRACTOR**

 Page 4 of 4  
 Dimensions are in inches (mm).

**DATE**
**B SERIES**
**SUPERSEDES**
**DRAWING NO.**

4 - 23 - 21

FL

2 - 12 - 21

FLAC-1