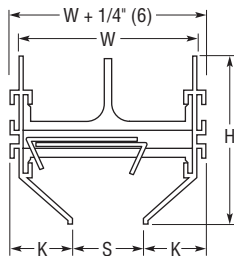
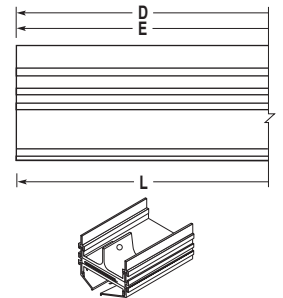
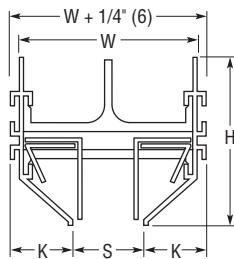
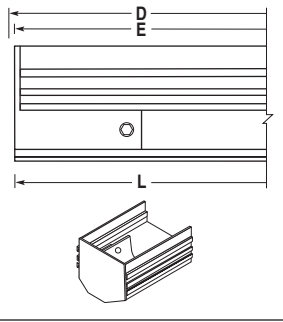

**FLH Horizontal High Throw Pattern Controllers**
 **Type KK Concealed Angular Frame**

- Drywall (ceiling, wall)

**End Condition**
**O Open End**

**FLV Vertical Jet Throw Pattern Controllers**
 **Type KK Concealed Angular Frame**

- Drywall (ceiling, wall)

**C Flat End Cap**

**Dimensional Data - Imperial (Metric) Units**

Model	S Slot Width	1 Slot W	K Border Width	H Height
FLH10, FLV10	1 (25)	2 1/2 (64)	7/8 (22)	2 3/8 (60)
FLH15, FLV15	1 1/2 (38)	3 1/2 (89)	1 1/8 (29)	2 5/8 (67)
FLH20, FLV20	2 (51)	4 1/2 (114)	1 3/8 (35)	2 7/8 (73)

**Notes:**

1. Material: Heavy duty extruded aluminum frame and spacers. Corrosion resistant steel pattern controllers.
2. Maximum section length is 72" (1823) by default. 96" (2438) and 120" (3048) are available as options. Lengths longer than the maximum section length are furnished in multiple sections with alignment strips, the number and size determined by the factory.
3. Adjustable pattern controllers are on 24" (610) centers.
4. Standard finish is MI Mill on exposed frames with black pattern controllers and interior surfaces.
5. Integral hanger brackets on 24" (610) centers. See separate submittal for optional mounting hardware and accessories.

**Options:**

- 
- SP Special Finish \_\_\_\_\_ .

**Overall Length and End Cap Position**

	E	L
<input type="checkbox"/> OO	D	D
<input type="checkbox"/> OC	D - 1/16 (2)	D - 1/16 (2)
<input type="checkbox"/> CC	D - 1/8 (3)	D - 1/8 (3)

**SCHEDULE TYPE**
**PROJECT**
**ENGINEER**
**CONTRACTOR**

Dimensions are in inches (mm).

**DATE**
**B SERIES**
**SUPERSEDES**
**DRAWING NO.**
**3 - 3 - 22**
**FL**
**5 - 10 - 18**
**FLH-3C**