



FLOWLINE™ LINEAR SLOT DIFFUSERS
ARCHITECTURAL • ALUMINUM
MODEL SERIES: FLH AND FLV TYPE CG

FLH Horizontal High Throw Pattern Controllers

One Slot

- Type CG Concealed Tapered/Flangeless Frame**
- Tape and Spackle (one side)
- Drywall (ceiling)

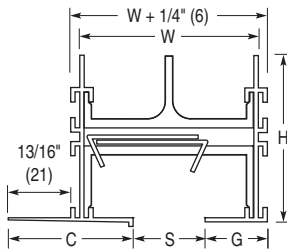

Two Slot

- Type CG Concealed Tapered/Flangeless Frame**
- Tape and Spackle (one side)
- Drywall (ceiling)

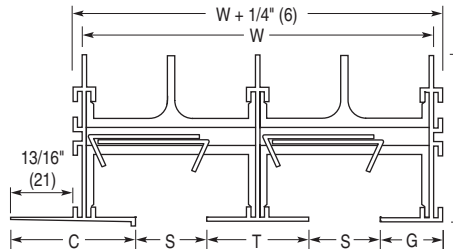

FLV Vertical Jet Throw Pattern Controllers

One Slot

- Type CG Concealed Tapered/Exposed Flange Frame**
- Tape and Spackle (one side)
- Drywall (ceiling)

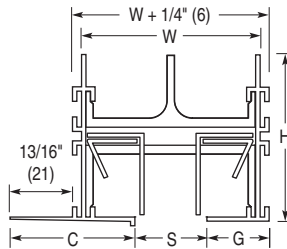

Two Slot

- Type CG Concealed Tapered/Exposed Flange Frame**
- Tape and Spackle (one side)
- Drywall (ceiling)

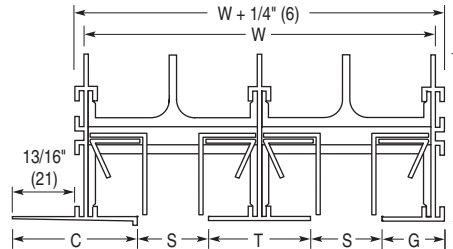

Dimensional Data - Imperial (Metric) Units

Model	S Slot Width	1 Slot	2 Slot	C Border Width	G Border Width	H Height	T 2 Slot
		W	W				
FLH10, FLV10	1 (25)	2 1/2 (64)	4 15/16 (125)	1 11/16 (43)	7/8 (22)	2 3/8 (60)	1 7/16 (37)
FLH15, FLV15	1 1/2 (38)	3 1/2 (89)	6 15/16 (176)	1 15/16 (49)	1 1/8 (29)	2 5/8 (67)	1 15/16 (49)
FLH20, FLV20	2 (51)	4 1/2 (114)	8 15/16 (227)	2 3/16 (56)	1 3/8 (35)	2 7/8 (73)	2 7/16 (62)
FLH25, FLV25	2 1/2 (64)	5 1/2 (140)	10 15/16 (278)	2 7/16 (62)	1 5/8 (41)	3 1/8 (79)	2 15/16 (75)
FLH30, FLV30	3 (76)	6 1/2 (165)	12 15/16 (329)	2 11/16 (68)	1 7/8 (48)	3 3/8 (86)	3 7/16 (87)

Notes:

1. Material: Heavy duty extruded aluminum frame and spacers. Corrosion resistant steel pattern controllers.
2. Maximum section length is 72" (1823) by default. 96" (2438) and 120" (3048) are available as options. Lengths longer than the maximum section length are furnished in multiple sections with alignment strips, the number and size determined by the factory.
3. Adjustable pattern controllers are on 24" (610) centers.

4. MI Mill finish is standard on frame/border C with an AW Appliance White finish on frame/border G and center tee on the 2 slot model. Pattern controllers and interior surfaces are black.
5. Integral hanger brackets on 24" (610) centers. See separate submittal for optional mounting hardware and accessories.

Options:

- SP Special Finish _____.

End Condition

O Open End

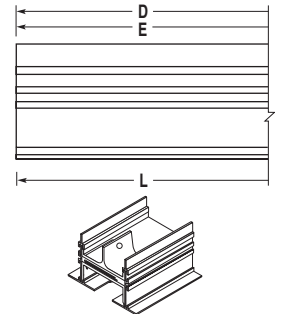

C Flat End Cap

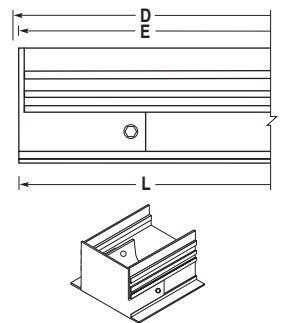

Overall Length and End Cap Position

	E	L
<input type="checkbox"/> OO	D	D
<input type="checkbox"/> OC	D - 1/16 (2)	D - 1/16 (2)
<input type="checkbox"/> CC	D - 1/8 (3)	D - 1/8 (3)

SCHEDULE TYPE

PROJECT

ENGINEER

CONTRACTOR

Dimensions are in inches (mm).

DATE

B SERIES

SUPERSEDES

DRAWING NO.

3 - 3 - 22

FL

9 - 26 - 18R

FLH-3F