



FIRE RATED ACCESS DOOR
INSULATED • FOR WALLS AND CEILINGS
MODEL: 0900-1



1 1/2 HR. 'B' LABEL IN WALLS



2 HR. LABEL IN CEILINGS
 3 HR. LABEL IN WALLS

DESCRIPTION:

The Nailor Model 0900-1 Fire Rated Access Door is approved by UL for 1 1/2 hours, 250°F max. temperature rise, 'B' label in walls and is approved by Warnock Hersey for 2 hours in ceilings and 3 hours in walls. The door meets ANSI-UL 10B standards. The same door can be used in walls and ceilings.

SPECIFICATIONS:

- Material:** Corrosion-resistant coated steel. 20 ga. (1.0) door and 16 ga. (1.6) frame.
- Finish:** Primed white finish standard.
- Door:** Flush to frame. Self-closing.
- Frame:** 4 piece welded frame with masonry mounting straps.
- Hinge:** Concealed pivot pins.
- Closure Spring:** Heavy duty. An extra spring is provided with every door for ceiling installation. Both springs must be attached to the door to ensure it will close when installed in the ceiling.
- Latch:** Flush mounted, interchangeable turn ring operator and key operator latch.
- Insulation:** Roxul 1280. 2" thick.
- Packaging:** One door per carton.

OPTIONS:

- Type 304 Stainless steel construction. # 4 finish.
- Special size. Specify _____.
- Cylinder lock.

STANDARD SIZES:

NOMINAL SIZE		SHIPPING WEIGHT lbs.
inches	mm	
8 x 8	203 x 203	10.0
12 x 12	305 x 305	14.0
16 x 16	406 x 406	16.5
18 x 18	457 x 457	19.0
24 x 24	610 x 610	30.0

Wall or ceiling opening = Nominal Size + 1/2" (13).

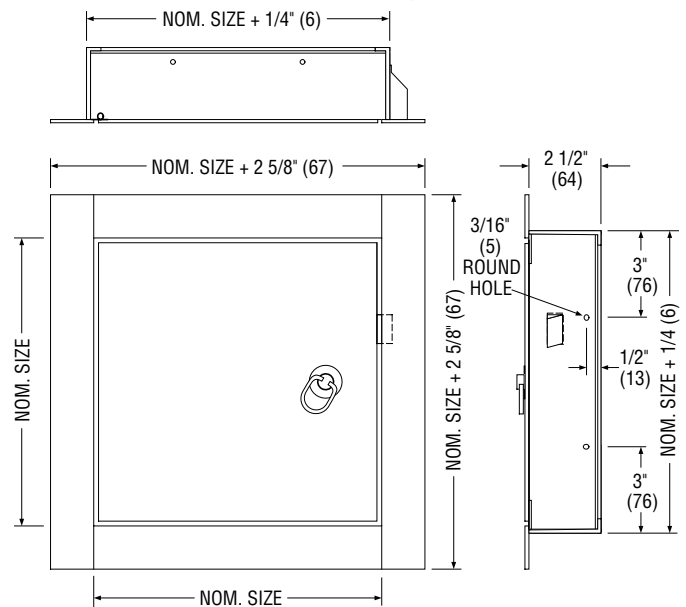
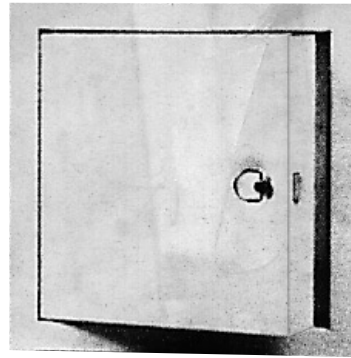

MASONRY INSTALLATION:

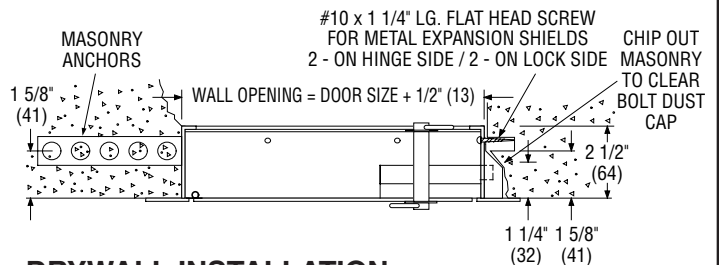

DRYWALL INSTALLATION:

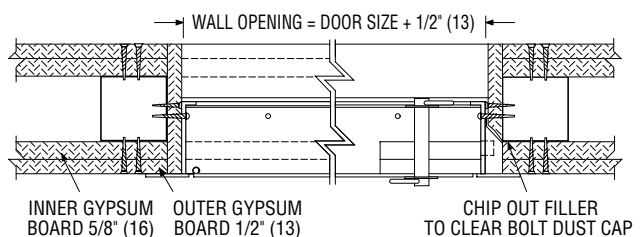

Dimensions are in inches (mm).

SCHEDULE TYPE:					
PROJECT:					
ENGINEER:		DATE	B SERIES	SUPERSEDES	DRAWING NO.
CONTRACTOR:		25 - 2 - 00R	0900	3 - 96R	0900-1



UNIVERSAL ACCESS DOOR
FOR MASONRY, DRYWALL OR PLASTER
WALLS AND CEILINGS
MODEL: 0900-2

DESCRIPTION:

The Nailor Model 0900-2 is a multi-purpose access door. It is designed for flush installation in drywall, block or tile, walls and ceilings. Frame features rounded safety corners, concealed hinge, flush with frame fit. It has a unique white finish. Door is formed for rigidity and safety.

SPECIFICATIONS:

- Material:** Corrosion-resistant coated steel. 14 gauge (2.0) door and 16 gauge (1.6) frame.
- Finish:** Primed white finish standard.
- Door:** Flush to frame. Turned back around edges for extra rigidity.
- Frame:** The frame has pre-punched holes for simple installation.
- Hinge:** Concealed pivot pins.
- Latch:** Flush mounted screwdriver operated cam is standard.
- Packaging:** One door per carton.

OPTIONS:

- Type 304 Stainless steel construction. # 4 finish.
- Special size. Specify _____.
- Cylinder lock.

STANDARD SIZES:

NOMINAL SIZE		SHIPPING WEIGHT lbs.
inches	mm	
8 x 8	203 x 203	2.8
10 x 10	254 x 254	3.8
12 x 12	305 x 305	5.0
16 x 16	406 x 406	7.9
18 x 18	457 x 457	9.8
24 x 24	610 x 610	15.9

Wall or ceiling opening = Nominal Size + 3/8" (10).

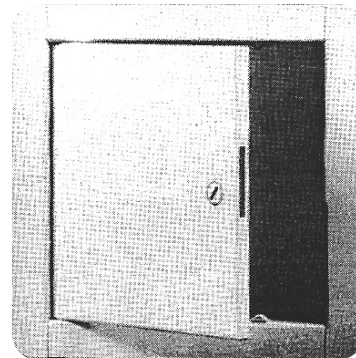

DIMENSIONAL DATA:

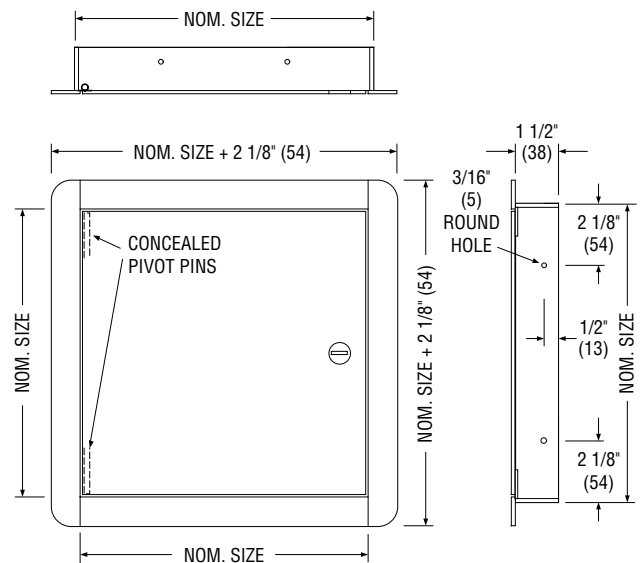

INSTALLATION DETAIL:

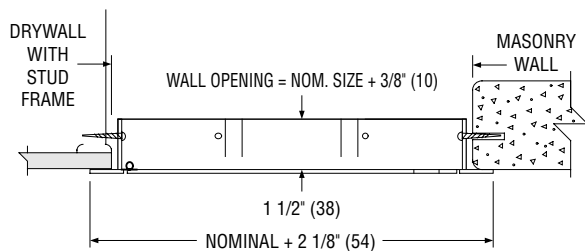

SCHEDULE TYPE:		Dimensions are in inches (mm).			
PROJECT:					
ENGINEER:	DATE	B SERIES	SUPERSEDES	DRAWING NO.	
CONTRACTOR:	25 - 2 - 00R	0900	3- 96R	0900-2	